

# TURBO JET

## CHANGING THE AMALGAM CONTAINER

It is not necessary to empty the amalgam container immediately when the alarm indicates 95%. Empty the container at the end of the working day.

1. Turn off the unit with the switch on the control panel
2. Place a new amalgam container (043130 pre 2010 or 043133 post 2010) underneath the drain tap to catch any excess liquid, then turn the drain tap vertical (the amalgam separator may require a light tap to break the air lock).
3. Turn the vent valve on the top of the amalgam separator anti clock-wise to open it so you can empty the excess liquid from the amalgam container. Wait 15 seconds.
4. Gently hold the collection container and slowly lift the stainless steel lever, the amalgam collection container can now be removed.
5. Top up the amalgam container to within 5mm of the rim with neat Puli-Jet Plus. Place the container on a solid surface and carefully place a new lid (201022) on top, twist and lock in position. Then push in the small plastic bung and twist to lock. The container is now airtight and safe for disposal\*. If re-using the original amalgam container, empty the contents into an approved amalgam waste container\*\*
6. Before replacing or refitting the new container treat the o-ring seal with a silicon based lubricant (not vaseline).
7. Replace with the new container (043130 pre 2010 or 043133 post 2010), place the new container into position carefully but DO NOT push up onto the separator. Relocate the stainless steel lever by pushing downwards to lock the container into place.
8. Turn the drain tap back to the horizontal position.
9. Turbo Jet (post 2010) only - Turn the vent valve on the top of the amalgam separator clock-wise to close it.

\* All waste amalgam must be handled and disposed of correctly, see your practice procedures for the disposal of hazardous waste and materials.

\*\* If the original container is to be re-used, place any small container under the tap and then empty into the approved waste container, do not pour down the sink. Clean the level sensing groove of the container with a cotton bud or similar.

The above are guidelines only, if you require further assistance please contact your engineer.

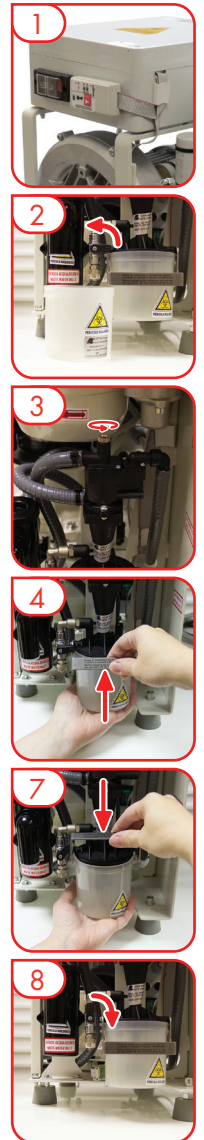

View on your phone or tablet



### HOW IS IT WE LEAD IN OUR FIELD, WHEN WE COST LESS THAN THE ALTERNATIVES? THIS IS HOW:

**Constant research:** this enables us to apply the latest technology to all of our products and solutions.

**We enhance performance:** electronic and information technology enable us to enhance the performance and reliability of our products.

**We reduce costs:** less maintenance and lower energy costs mean that we are always the most economical on a cost-benefit analysis.

**We reduce environmental impact:** we save 50% on raw materials, so that you can save between 30% and 50% on electrical consumption.